

EXTENSION FIRST FLOOR (E1)

JOHN H. REAGAN
BUILDING TUNNEL

TEXAS WORKFORCE COMMISSION and
ROBERT E. JOHNSON BUILDING TUNNEL

State Representatives:
E1.200's through E1.500's

Senators:
E1.600's through E1.800's

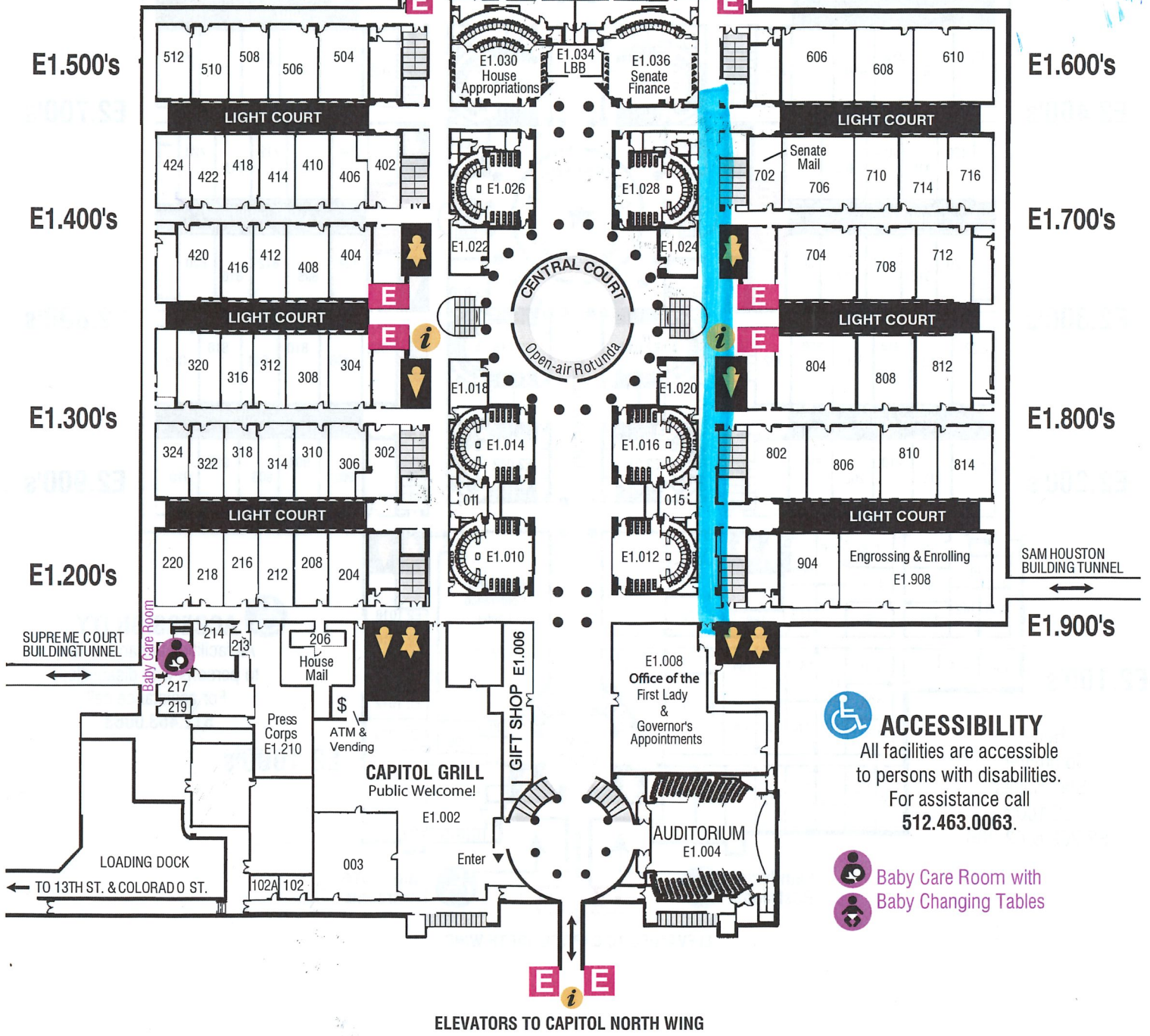

 **ACCESSIBILITY**
All facilities are accessible
to persons with disabilities.
For assistance call
512.463.0063.

 Baby Care Room with
 Baby Changing Tables

E i E
ELEVATORS TO CAPITOL NORTH WING

CAPITOL EXTENSION GUIDE FLOOR E1